

# NH Route 12A Residential Zone

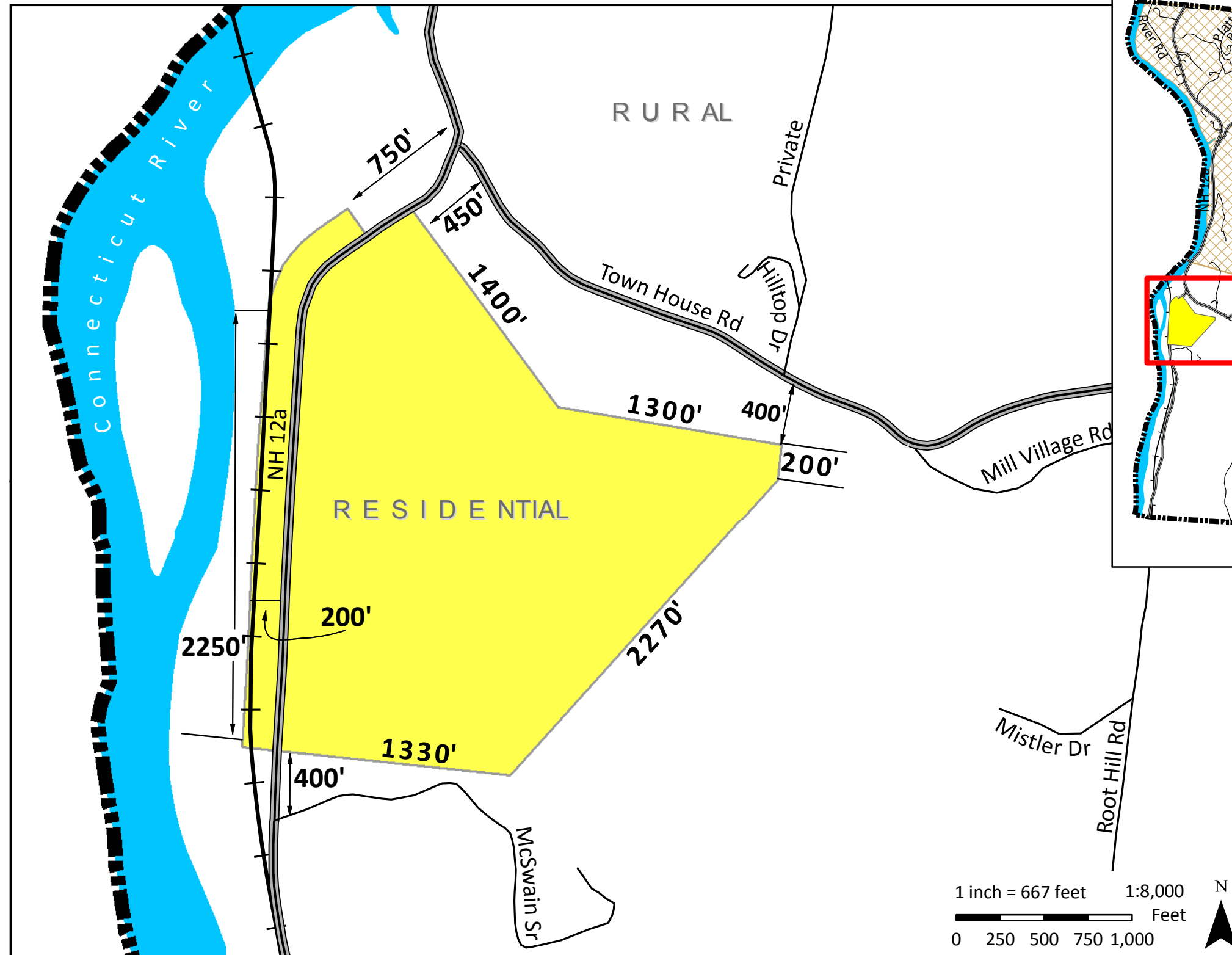

- Zoning District**
- Rural District
  - Residential Districts
  - Village Districts
  - Non-Manufactured Housing Overlay District (Other Overlay Districts are not shown - refer to Zoning)
- Roadways**
- State
  - Local; Not Maintained; Private
  - ++ Railroad
  - Town Boundary
  - Connecticut

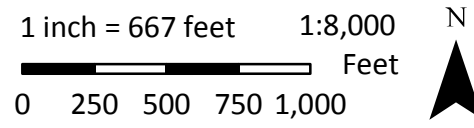

This map is intended for reference and planning purposes only. While this map represents the best available data, the Town of Cornish and UVLSRPC make no claim as to the validity or reliability of these data.

**Data Sources:** Zoning districts developed from Cornish Zoning Maps of 1992 and 1974 and the 2009 Cornish Zoning Ordinance, by UVLSRPC, 2009. Roads from the NH Department of Transportation, 2008, with updates from Cornish town maps and Cornish Planning Board. Connecticut River from NH Hydrography Dataset from CSRC, UNH, 2006. Town boundaries (revised to match Cornish tax map) and railroad from CSRC, UNH, 1992. Statewide datasets (1:24,000 scale) distributed by Complex Systems Research Center (CSRC), University of New Hampshire (UNH) via NH GRANIT.

**Disclaimer:** Digital data in NH GRANIT represent the efforts of the contributing agencies to record information from the cited source materials. CSRC, under contract to the Office of Energy and Planning (OEP), and in consultation with cooperating agencies, maintains a continuing program to identify and correct errors in these data. OEP, CSRC, and the cooperating agencies make no claim as to the validity or reliability or to any implied uses of these data.

